

Why Buy ChoiceDek[®]

- » Durable, reliable and cost-effective
- » 25-year Warranty
- » No painting, sealing or staining
- » Resists stains, mold and mildew all the way to the core
- » Simple to install and easy to clean
- » 95% recycled content
- » Can be installed on or in the ground and even underwater
- » Variety of colors and matching railing systems to complement any home
- » Looks and feels like wood
- » Hidden Fastener compatible

Deck Board

Length: 8*, 12, 16 and 20 ft.
Actual Dimensions: 1.0 in. x 5.4 in.
Grain: Wood

* 8 ft. boards only available in Beach House

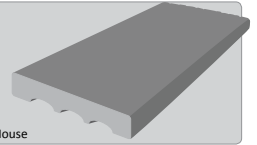

Post Sleeve

Length: 48 in.
Actual Dimensions: 4.375 in. x 4.375 in.
Grain: Wood

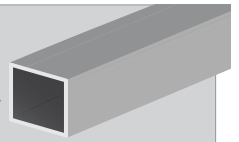

Baluster

Length: 31 in. (38 in. SOS)
Actual Dimensions: 1.5 in. x 1.265 in.
Grain: Wood

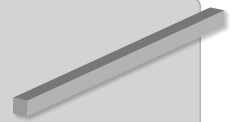

Speed Rail

Length: 6 ft.
Actual Dimensions: 1.5 in. x 3.5 in.
Grain: Wood

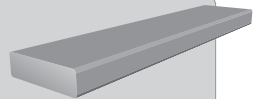

Trim Board

Length: 8* and 12 ft.
Actual Dimensions: .67 in. x 11.25 in.
Grain: Wood

* 8 ft. boards only available in Beach House Gray

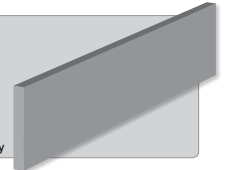

Post Cap

Actual Dimensions:
5.7 in. x 1.8 in. x 5.7 in.
Grain: Smooth

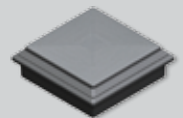

Post Collar

Actual Dimensions:
6.1 in. x 1.5 in. x 6.1 in.
Grain: Smooth

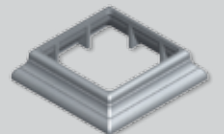

Interested In A Different Color?

Take these item numbers to Pro Services to order our other color options. Special ordering is quick and easy!

ChoiceDek SOS Decking Item #: 231078
ChoiceDek SOS Railing & Accessories Item #: 289435

Beach House Gray Deck Boards

Stock #	Product Description
371959	8 ft. Non-grooved
28667	12 ft. Non-grooved
29047	16 ft. Non-grooved
29229	20 ft. Non-grooved
371961	12 ft. Grooved
371963	16 ft. Grooved
379673	20 ft. Grooved



Coastal Redwood Deck Boards

SOS #	Product Description
221839	12 ft. Non-grooved
219813	16 ft. Non-grooved
234690	20 ft. Non-grooved
221865	12 ft. Grooved
221967	16 ft. Grooved
222015	20 ft. Grooved



Harvest Brown Deck Boards

SOS #	Product Description
228427	12 ft. Non-grooved
257061	16 ft. Non-grooved
257069	20 ft. Non-grooved
228510	12 ft. Grooved
228526	16 ft. Grooved
228547	20 ft. Grooved



All railing and accessories are also available in the three color options. Please visit www.choicedek.com/installation for our installation instructions.

Available
exclusively at:



FREQUENTLY ASKED QUESTIONS

What is ChoiceDek[®]?

ChoiceDek[®] is a decking product manufactured by A.E.R.T. that never needs painting or staining. ChoiceDek[®] is made from 95% recycled materials and can be installed with ground contact or in water.

How is ChoiceDek[®] manufactured?

ChoiceDek[®] is manufactured under several unique patents in a process wherein the wood fibers are aligned and encapsulated in plastic. The plastic surrounds and bonds to the wood fibers, making them virtually moisture proof. The wood fibers reinforce the plastic, making it stiffer and greatly reducing its thermal movement. ChoiceDek[®] decking planks are extruded and allowed to cure slowly, which means the boards will not twist or warp.

Does ChoiceDek[®] contain any preservative treatments?

No. ChoiceDek[®] is virtually impervious to moisture and does not require pressure treatment, preservative treatments, water sealing or staining.

Where can I see or purchase ChoiceDek[®]?

ChoiceDek is exclusively available at Lowe's Home Center. Visit choicedek.com to view our deck gallery.

What sizes does ChoiceDek[®] come in?

The wide range of ChoiceDek decking and railing products give you the flexibility to create a truly distinctive custom deck. Boards come in 8-feet (only available in Beach House Gray), 12-feet, 16-feet and 20-feet standard lengths.

What is the warranty on ChoiceDek[®]?

ChoiceDek[®] is manufactured by Advanced Environmental Recycling Technologies. A.E.R.T. has a 25-year warranty on its engineered components against rot or fungal rot, termites or insect damage, when installed following the Installation Guide for ChoiceDek[®] Decking and Railing and in compliance with applicable building codes and good construction practices. Visit choicedek.com for more details.

How does ChoiceDek[®] stand up against termites?

ChoiceDek[®] has been extensively tested for termite resistance. In fact, ChoiceDek[®] was even buried in Formosan Termite Mounds in Hawaii for over nine months and successfully withstood a continuous hostile termite exposure.

Will ChoiceDek[®] rot or decay like wood?

No. ChoiceDek[®] has been extensively tested under hostile accelerated aging conditions by outside laboratories. It is warranted to resist rot and fungal decay when properly installed and maintained. See A.E.R.T.'s warranty for details. www.choicedek.com/warranty/

Will ChoiceDek[®] decking fade?

Our colors are designed to weather slightly to more natural shades within the first six months.

Does ChoiceDek[®] require painting or staining?

No. ChoiceDek[®] does not require painting or staining. As with any outdoor surface, periodic cleaning is required.

Is ChoiceDek[®] stain proof?

ChoiceDek[®] is stain resistant. Most stains commonly encountered such as mustard and ketchup will wash away easily. More stubborn stains can be washed off with the proper cleaner. Please call customer service at 800-951-5117 regarding stain cleaning.



FREQUENTLY ASKED QUESTIONS

How do I clean ChoiceDek[®]?

ChoiceDek[®] can be cleaned with many commercially available deck washes. Stubborn stains may require a deck cleaner containing oxalic acid (bleach). Additional cleaning tips can be found at <http://www.choicedek.com/care-cleaning/>. ChoiceDek[®] decking can be power washed without harming the product if you follow this guideline: Avoid extreme pressures above 1,300 PSI and maintain spray jets 8-inch - 10-inch from the deck surface for best results.

How does ChoiceDek[®] react to incidental salt water contact or spray?

ChoiceDek[®] will withstand the most hostile environment, including incidental saltwater contact or spray in coastal areas. Encapsulation is the key to ChoiceDek's[®] durability and long life in difficult environments. In all environments stainless steel screws are recommended.

What type of fasteners are recommended?

To minimize the chance of metal corrosion stains, always install ChoiceDek[®] with stainless steel trim head screws. Regular steel fasteners or electroplated deck screws or fasteners are not recommended, as they can leave ugly rust stains on any deck. ChoiceDek[®] can be installed using a hidden fastening system like the Mantis model 396 (Order from Pan American Screw 800-951-2222). If a hidden fastening system is not used, the manufacturer recommends 2¼-inch #7 stainless steel trim-head screws.

What type of tools are required?

ChoiceDek[®] can be easily installed with standard woodworking tools, including hammer, skill saw, rasp, level, and square. Standard carbide saw blades with less than 20 teeth are recommended. Please use blue chalk since other color chalk may stain the deck.

Are installation guidelines or videos available?

Yes. View the ChoiceDek[®] brochure in English or Spanish at <http://www.choicedek.com/installation/>. Additional details can also be obtained by contacting Customer Service at 800-951-5177.

How is ChoiceDek[®] rated?

ChoiceDek[®] has a Class C fire rating, similar to wood. Residential decking has a uniform live load of 150 psf when spanned on 16-inch centers. Please see ICC Building Code Requirements.

Is polyethylene plastic toxic and does it give off toxic fumes when burned?

No. Polyethylene is non-toxic and is used for applications such as milk jugs, water jugs and grocery sacks. When burned completely, it will convert to carbon dioxide and water vapor.

How sturdy is the material?

ChoiceDek[®] can be installed residentially and commercially. Some commercial examples include the initial commercial boardwalk that was installed in 1992 at the South Padre Convention Center at South Padre Island, TX. Other notable installations include the Cape Cod National Seashore, MA; Fire Island National Park, NY; the Morrison Knudsen Nature Center in Boise, ID; and Knots Berry Farm, CA.

How do I order product, get pricing, availability, delivery times, or status of an order?

SOS numbers: 231078 for decking and trim/ 289435 for railing and accessories. Contact your local BlueLinX, or call 888-502-BLUE(2583).

For any other questions please contact Customer Service at 800-951-5117 or visit www.choicedek.com

